

convene™

333 SOUTH GRAND AVENUE

CONVENE.COM | 888-730-7307

333 South Grand Avenue

MEETINGS & EVENTS



5

MEETING ROOMS

250

MAX. THEATER

20,000

SQUARE FEET

Convene at the Wells Fargo Center is the ideal venue to host your next meeting or event, with over 20,000 square feet of dedicated event space offering everything from small boardrooms to large conference space. This location evokes an “industrial chic” environment with neutral tones featuring pops of color, and wood accents. The space can host up to 500 guests for a reception.



Essential Elements Included:



HIGH-SPEED
WIFI



FLEXIBLE MEETING
AND EVENT SPACE



ON-SITE GOURMET
CHEF



STATE-OF-THE-ART
TECHNOLOGY



EVENT PLANNING
SERVICES



UNLIMITED ON-SITE
DRINKS AND SNACKS



Floorplan & Capacities

333 SOUTH GRAND AVENUE

3RD FLOOR	DIMENSION (FT)	AREA (FT ²)	CEILING HEIGHT (FT)	RECEPTION	THEATER	CLASSROOM	BOARDROOM	U-SHAPE	PODS	ROUNDS	WORKING LOUNGE
Meeting & Event Space											
The Forum	65' x 40'	2,600'	12'	250	250	147	n/a	48	147	160	n/a
The Broadroom 3	22' x 31'	682'	9'	n/a	n/a	n/a	16	n/a	n/a	n/a	n/a
The Beach Hub	45' x 34'	1,530'	12'	70	120	60	32	36	70	96	n/a
The Library Hub	47' x 25'	1,175'	12'	50	98	69	28	30	70	72	n/a
The Arts Hub	46' x 25'	1,150'	12'	50	103	63	18	36	70	80	n/a
Gallery Space											
The Welcome Gallery 3	27' x 48'	1,005'	12'	60	n/a	n/a	n/a	n/a	n/a	48	35
The Prow Gallery 3	33' x 65'	2,350'	12'	150	n/a	n/a	n/a	n/a	n/a	105	91
The Plaza Gallery	45' x 31'	1,659'	12'	150	n/a	n/a	n/a	n/a	n/a	75	67

3rd Floor

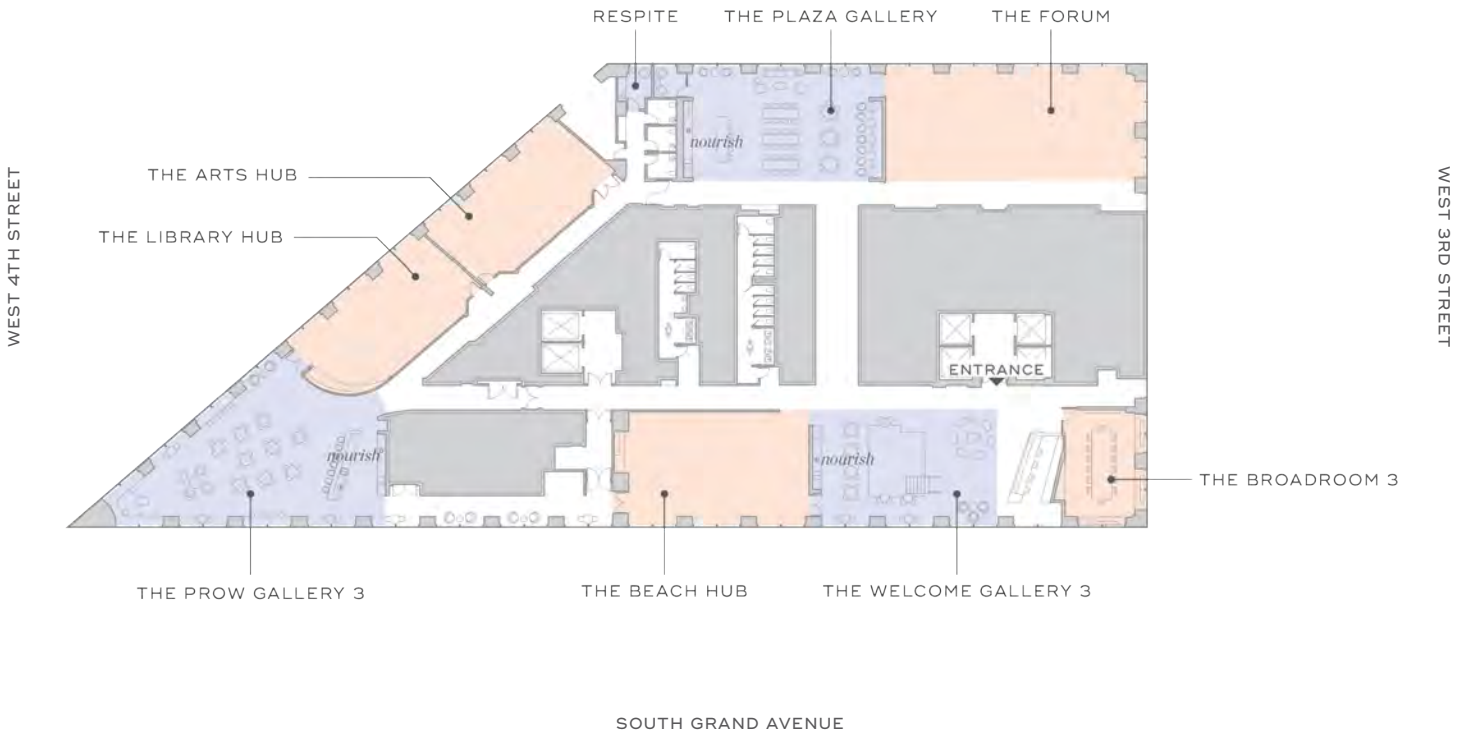

Room Types

We practice a human-centered design approach to optimize meeting types as well as room typologies that support the unique needs of small, medium, or large corporate meetings.



The Boardroom 3 at 333 S. Grand Ave, LA

Boardroom

Small Format Meetings (2-16 participants)

Boardrooms support small meetings of up to 16 participants and include resources that promote successful decision making and idea generation.



The Library Hub at 333 S. Grand Ave, LA

Hub & Studio

Medium Format Meetings (15-120 participants)

Hubs and studios are medium sized multi-purpose rooms that are flexible to host 15-120 participants. Their design facilitates intense engagement and collaboration.



The Forum at 777 S. Figueroa St, LA

Forum

Large Format Meetings (75-250 participants)

Forums support large format meetings by anticipating the complex audiovisual requirements of presentations and training programs.



The Olympic Gallery at 777 S. Figueroa, LA

Gallery Spaces

Community Areas (60+ participants)

These transformative spaces flex to support the activities that happen before, in-between, and after your program, including registration, dining, networking, receptions, and social events.

Fully Integrated Experiences

We integrate our meeting, training, and event services into every program so that planners can focus on ensuring that every participant has a great experience.



Spiced Leg of Lamb

Cuisine

We have studied the art of serving large groups and curated fresh seasonal menus to satisfy every palate and personality.



Technology at 32 Old Slip, NYC

Technology

State-of-the-art technology comes standard with all of our meeting packages. Other services include dedicated support, built-in power, broadcasting, and high-speed Wi-Fi.



The Welcome Gallery 3 at 333 S. Grand Ave, LA

Production & Planning Support

Our dedicated production managers can assist with all of your event planning, logistics, and day-of execution needs.



Passed Hors d'oeuvres at 117 W 46th Street, NYC

Service Support

Our on-property General Manager and Service Managers ensure that your spaces are properly set up, always clean, and filled with all the supplies and nourishment you need to be productive.

Meeting & Event Packages

Convene integrates all the elements of a successful meeting or event into all-inclusive packaged pricing options.



The Prox Gallery 3 at 333 S. Grand Ave, LA

Choose from our most popular meeting and event packages, or further customize a package based on your needs.

BASIC PACKAGE

Nourish Café - All day access
Gourmet coffee and beverages, sweet and savory snacks, fresh fruit, and candy

Continental Breakfast

Lunch

- 2 Seasonal Salads
- 1 Protein Salad
- 2 Sandwiches
- 1 Dessert

Technology

+ In-room technology

STANDARD PACKAGE

Nourish Café - All day access
Gourmet coffee and beverages, sweet and savory snacks, fresh fruit, and candy

Breakfast - Cold & Hot

Lunch

- 2 Seasonal Salads
- 1 Protein Salad
- 2 Sandwiches
- 1 Hot Entrée
- 1 Dessert

AM & PM Break

Technology

+ In-room technology

PREMIUM PACKAGE

Nourish Café - All day access
Gourmet coffee and beverages, sweet and savory snacks, fresh fruit, and candy

Breakfast - Enhanced Cold & Hot

Lunch

- 2 Seasonal Salads
- 1 Protein Salad
- 1 Sandwich
- 2 Hot Entrées
- 1 Hot Side
- 2 Desserts

AM & PM Break









Technology

+ In-room technology

Technology Inclusions & Enhancements

All of our meetings and events come with in-room, user-controlled technology and equipment. Whatever your meeting or event size, we can accommodate your most advanced technology needs.

All Packages Include:

 1 GB HIGH-SPEED WI-FI	 PRESENTATION PODIUM	 OFFICE SUPPLIES	 DIGITAL SIGNAGE
 BUILT-IN PROJECTION	 FLIPCHART, EASEL & WHITEBOARD	 AUDIO EQUIPMENT	 TECH MANAGER ON-SITE



The Hub, 777 S. Figueroa St, LA

In addition to our all-inclusive meeting and event packages, technology enhancements may be added to any package. We provide a range of options based on your specific meeting or event goals.

<p>Audio Enhancement Options</p> <ul style="list-style-type: none"> • Audio recording • Powered speaker bundle* • Push to talk microphone system • Audio mixer (Up to 32 channels) • Podium with microphone • Boundary microphone • Tabletop microphone • Wireless handheld microphone • Wireless lavalier microphone 	<p>Video Enhancement Options</p> <ul style="list-style-type: none"> • Digital displays (various sizes up to 90") • Confidence monitor • Laptop • Additional projector and projector screen • Video switcher <p>Networking Enhancement Options</p> <ul style="list-style-type: none"> • Dedicated internet bandwidth • SSID customization • Wired internet connection • Public IP address • Hard-line internet connectivity 	<p>Miscellaneous Enhancement Options</p> <ul style="list-style-type: none"> • LED uplights • Staging and draping • Additional stage lighting • Speaker timer system • Upgraded presentation bundle* • Black & white printer • Color printer • Dedicated tech specialist • Additional whiteboard flip-chart easel and markers • Audio conferencing speaker phone • Document camera • Basic videography bundle* • Premium videography bundle* • Live polling and Q&A, powered by Slido
<p>Conference & Livestream Enhancement Options</p> <ul style="list-style-type: none"> • Point to point video conference • Web conference bundle* • Essential webinar bundle* • Basic webinar bundle* • Premium webinar bundle* <p><i>Webinar powered by Livestream</i></p>		

*Ask your sales or technology manager for more information on what is included in bundles and pricing.

Our Locations



For more information or
to schedule a site tour, please
visit convene.com or call
888-730-7307