

MEETING AND EVENT SPACE

2001 Market Street



Convene Commerce Square is Philadelphia's most premium meeting and event venue. Purposefully-designed for collaboration and productivity, this venue features unique spaces available for meetings and events of all sizes, from small board meetings to large receptions. The space has plenty of natural light and a design concept paying homage to Philly's 1920's theater scene with rooms resembling grand theaters around the world.

HIGH-SPEED
WIFIFLEXIBLE MEETING
& EVENT SPACEON-SITE
GOURMET CHEFSTATE OF THE ART
TECHNOLOGYEVENT PLANNING
SERVICESUNLIMITED ON-SITE
DRINKS & SNACKS

11

MEETING ROOMS

400

MAX ROOM CAPACITY

42,000

SQUARE FEET



Floorplan & Capacities

2ND FLOOR

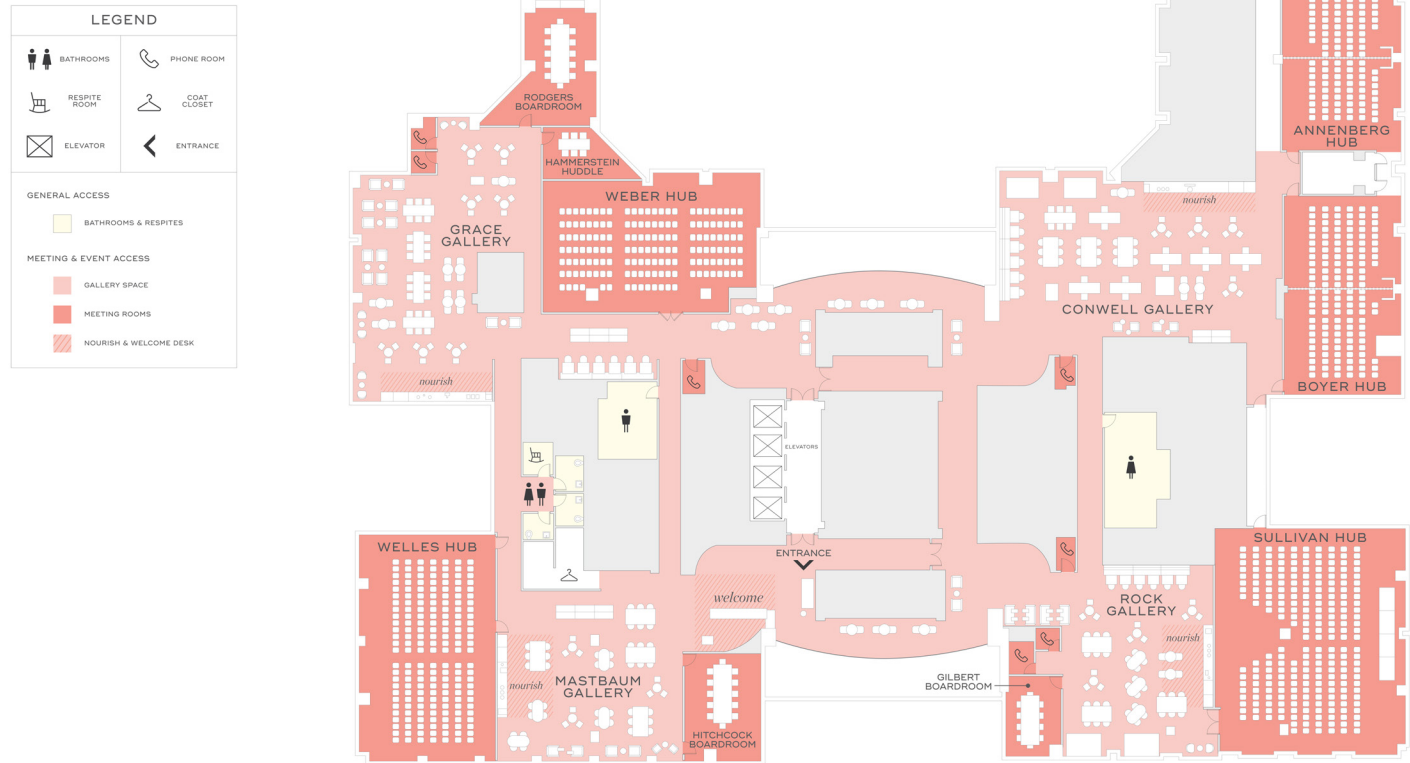

	DIMENSION [FT]	AREA [SQ FT]	CEILING HT [FT]	RECEPTION	THEATER	CLASSROOM	CONFERENCE	U-SHAPE	PODS
Weber Hub	56' x 33'	1,899'	10'	n/a	130	99	66	42	98
Annenberg Hub	59' x 31'	1,769'	9'	n/a	156	129	60	33	112
Annenberg Hub East	24' x 31'	744'	9'	n/a	66	45	28	22	42
Annenberg Hub West	35' x 31'	1,085'	9'	n/a	90	69	36	27	42
Boyer Hub	51' x 30'	1,599'	9'	n/a	120	92	60	40	98
Boyer Hub East	27' x 31'	837'	9'	n/a	66	36	18	28	42
Boyer Hub West	24' x 31'	744'	9'	n/a	55	36	18	28	42
Sullivan Hub	59' x 48'	2,910'	15'	n/a	400	162	66	50	140
Welles Hub	59' x 35'	2,088'	15'	n/a	170	102	66	42	112
Hammerstein Huddle	19' x 13'	259'	10'	n/a	n/a	n/a	6	n/a	n/a
Gilbert Boardroom	21' x 14'	295'	10'	n/a	n/a	n/a	10	n/a	n/a
Rodgers Boardroom	32' x 18'	648'	10'	n/a	n/a	n/a	18	n/a	n/a
Hitchcock Boardroom	27' x 19'	541'	9'	n/a	n/a	n/a	14	n/a	n/a
Grace Gallery	56' x 36'	2,932'	10'	150	n/a	n/a	n/a	n/a	n/a
Conwell Gallery	73' x 43'	3,040'	10'	150	n/a	n/a	n/a	n/a	n/a
Rock Gallery	39' x 48'	1,902'	10'	120	n/a	n/a	n/a	n/a	n/a
Mastbaum Gallery	49' x 44'	2,254'	9'	130	n/a	n/a	n/a	n/a	n/a